

## PRESSURE SWITCH

*for Wet Piping Systems with Jokey Pump.*

It is put in the trap or suction tube and its function consists of detecting a sudden rise of the pressure in the trap, caused by the discharge of the agent.

- Ease of wiring to the detection station, NO or NC.
- Rapid restart, only pulling the lateral knob.
- Effective and reliable because of its simplicity of functioning.
- Available in 1/4" or 1/2" GM connections
- Long term and excellent resistance and durability against totally electrical devices.

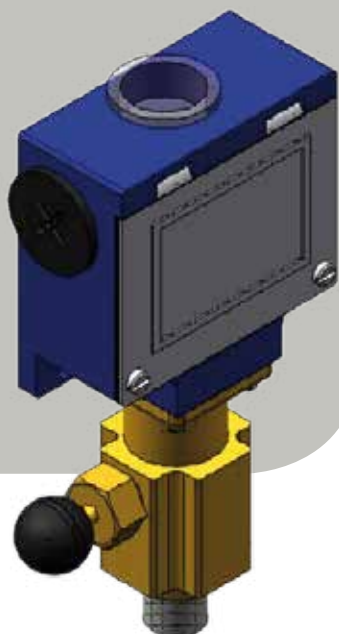

### MODELS:

**POINPRE 6-40L / 15-40L / 6-40I / 15-40I**

IT IS USED AS AN ELECTRICAL CONTACT FOR THE AUTOMATION OF ANY KIND OF MANEUVER IN CASE OF FIRE (for example: blower stop, trap doors close, etc.). It can also be connected to the fire station to send a real outflow signal of mist water.

This application is very useful in cases when the water is released by accident (without activation of the fire detection), avoiding that this fact goes unnoticed and that appropriate measures are not taken.

They are activated when the calibration pressure is exceeded, normally when the main pump is turned on.

The pressure switches are available in NO contacts (normally open) or NC (normally closed).

MODEL	Ø A	Bar	Material
POINPRE 6-40L	1/4" BSP	40 ± 8 Bar	Brass CuZn40Pb2 (CW617N)
POINPRE 15-40L	1/2" BSP	40 ± 8 Bar	Brass CuZn40Pb2 (CW617N)
POINPRE 6-40I	1/4" BSP	40 ± 8 Bar	Stainless Steel AISI 303
POINPRE 15-40I	1/2" BSP	40 ± 8 Bar	Stainless Steel AISI 303

- Magnified bursting pressure and absence of leaks thanks to its design.
- Totally watertight.
- Resistance to high temperatures; they guarantee an optimal efficiency in extreme conditions.
- Available in AISI316 steel.
- High stability against impacts and vibrations.
- **RG-SYSTEMS also have this device in ATEX version.**